

10/5/87

United States Department of the Interior
National Park Service

National Register of Historic Places Continuation Sheet

Section number _____ Page _____

Anderson Downtown Historic District
(Boundary Increase)
Anderson County, SOUTH CAROLINA

BOUNDARY INCREASE

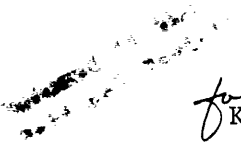
for Keeper Alvin Byer 11/5/87

**United States Department of the Interior
National Park Service**

**National Register of Historic Places
Inventory—Nomination Form**

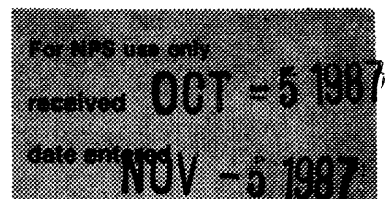

Anderson Downtown Historic District Expansion -
Continuation sheet John C. Calhoun Hotel Item number

Page 1

EXPANSION OF ANDERSON DOWNTOWN HISTORIC DISTRICT

The John C. Calhoun Hotel at 402 N. Main Street (southeast corner of Sharpe Street) in Anderson is an eight-story reinforced concrete building with a brick veneer. It is located adjacent to the Anderson Downtown Historic District (listed in the National Register on February 23, 1979). The district is primarily significant as a well-preserved late nineteenth and early twentieth century commercial area featuring a variety of architectural forms popular during the period. In the post-Reconstruction era, Anderson experienced a significant amount of building and rebuilding, a phenomenon which continued well into the twentieth century. This hotel is illustrative of that growth.

Begun as a local project by the Anderson Community Hotel Corporation in February 1924, and completed the following year, the John C. Calhoun Hotel was designed by James J. Baldwin and Joseph H. Casey, prominent Anderson architects of the period.(1) Fiske-Carter Construction Company, one of South Carolina's largest firms in the 1920's, built the hotel.(2) The John C. Calhoun Hotel played an important role in the development of the downtown business district that served as the governmental, commercial, and cultural center of Anderson County. It was an active hotel for approximately thirty-five years from its construction to the advent of motels in the early 1960's. The building remains as a good and essentially intact example of an early twentieth century hotel.

The Calhoun Hotel is a flat roofed, L-shaped building displaying neoclassical elements. The primary entrance is centrally located on the N. Main Street facade. Three storefront divisions flank the entrance and have undergone some minor alterations. A secondary entrance is located on the Sharpe Street facade. The exterior fabric at street level is concrete scored to simulate stone. The lobby/mezzanine level is defined by a seven-bay arrangement on the N. Main Street facade and a six-bay arrangement on the Sharpe Street facade of large round-headed windows. These windows consist of eight-over-eight double hung sash with fanlights and sidelights. The windows feature brick surrounds, concrete corner blocks and modillion keystones. A concrete band cornice separates this level from the upper floors, the fenestration of which is characterized by six-over-six windows in an

**United States Department of the Interior
National Park Service**

**National Register of Historic Places
Inventory—Nomination Form**

Anderson Downtown Historic District Expansion -
John C. Calhoun Hotel

Continuation sheet

Item number

Page 2

For NPS use only

received

Date entered

eleven-bay pattern with double windows at the corners of the N. Main and Sharpe Street facades and at the center of the N. Main Street facade. Another concrete cornice separates the seventh and eighth floors. The windows on all upper floors feature concrete sills and soldier course brick lintels. The building is capped by a concrete and brick parapet.

The lobby and mezzanine area retains integrity, and features a beamed ceiling, plaster ornamentation, a tile floor, marble baseboards, marble and wood wainscotting, and what appear to be early or perhaps original lighting fixtures.

Professional error led to the exclusion of the John C. Calhoun Hotel from the district when the nomination was prepared in 1978. Because the Calhoun Hotel is adjacent to the Anderson Downtown Historic District, the UTM coordinates for the district will not change. A map showing the new boundaries of the district is attached. Acreage less than 1/2 acre.

Christie Z. Jawl, Deputy SHPO

George L. Vogt

State Historic Preservation Officer

9/29/87

Date

**United States Department of the Interior
National Park Service**

**National Register of Historic Places
Inventory—Nomination Form**

Anderson Downtown Historic District Expansion -

Continuation sheet John C. Calhoun Hotel

Item number

Page 3

For NPS use only

received

date entered

NOTES

(1) Book W5, p. 435, Anderson County Deeds, Anderson County Courthouse, Anderson, S. C.

(2) Manufacturers Record, August 14, 1924, p. 107; August 28, 1924, p. 113.

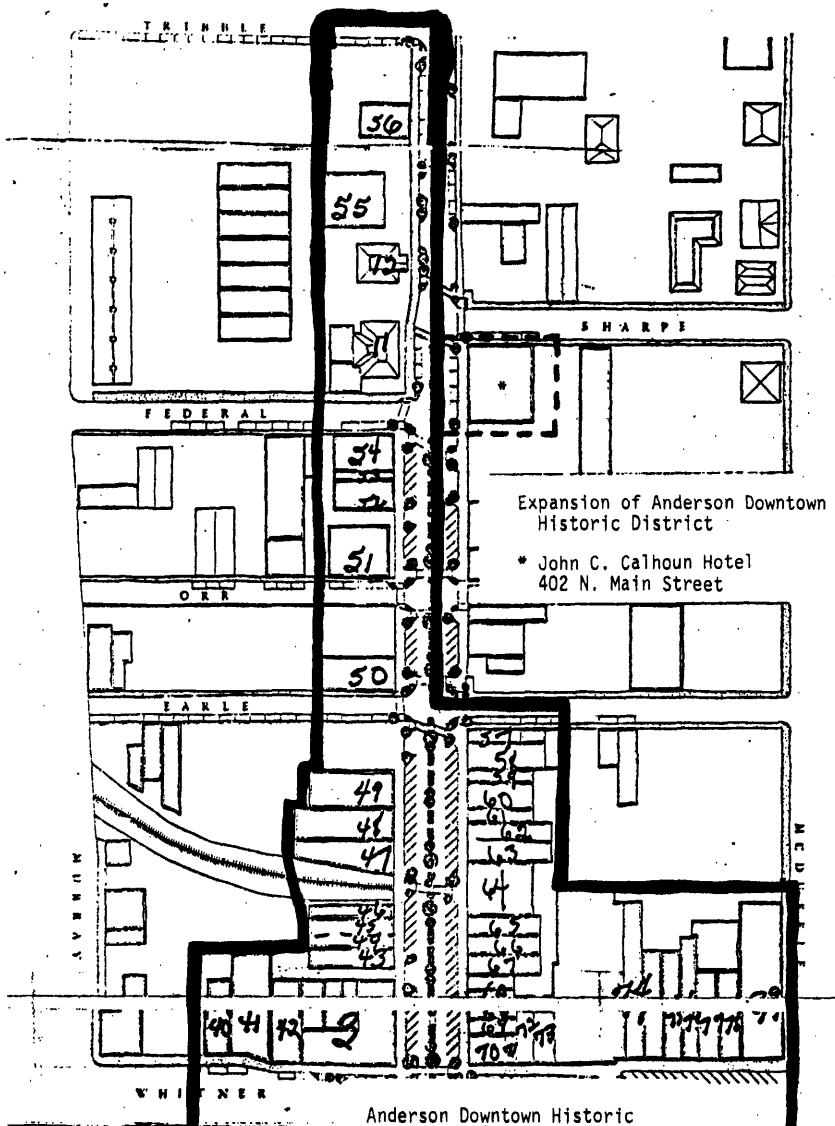

Expansion of Anderson Downtown Historic District
 * John C. Calhoun Hotel
 402 N. Main Street

Anderson Downtown Historic District (Existing)

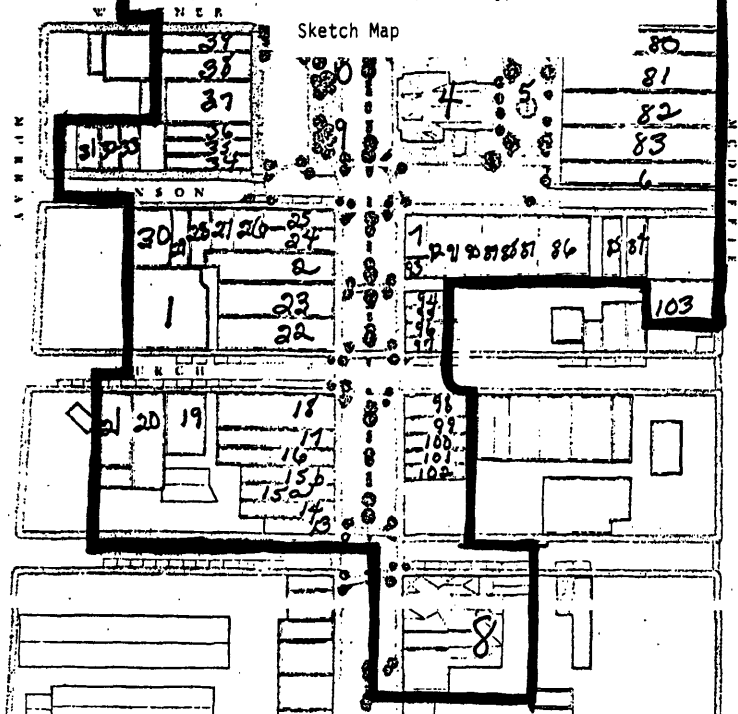

Sketch Map